



TOWNSHIP HIGH SCHOOL DISTRICT 211

**WEDNESDAY  
OCTOBER 10, 2018**

**6:30 - 8:30 p.m.**

Doors Open At 6:30 p.m.

**PALATINE HIGH SCHOOL**  
1111 N. Rohlwing Rd., Palatine



A program for Township High School District 211 students and their parents presented by the Student Services Departments.

Dear Parents and Students:

Welcome to the 2018 High School District 211 College Night. We hope that the information you obtain here this evening will be helpful in your college planning.

The institutions listed on the following pages represent colleges of a variety of types from various parts of the country. The college representatives are prepared to discuss admission requirements and procedures, curriculum offerings, scholarships, financial aid information, housing options, and programs for advanced study.

Once you have had the opportunity to look over the information and material you receive, you may have further questions. Please feel free to contact your high school's college counselor for clarification or additional information.

## ***COLLEGE COUNSELORS***

### **Palatine High School**

Shannon O'Brien 847-755-1648  
sobrien@d211.org

### **William Fremd High School**

John Baima 847-755-2643  
jbaima@d211.org

### **James B. Conant High School**

J.C. Brown 847-755-3649  
jcbrown@d211.org

### **Schaumburg High School**

Nick Kostalek 847-755-4649  
nkostalek@d211.org

### **Hoffman Estates Fremd High School**

Michael Murphy 847-755-5630  
mmurphy@d211.org

## ***TOWNSHIP HIGH SCHOOL DISTRICT 211 BOARD OF EDUCATION***

Mucia Burke, *President*

Will Hinshaw, *Vice President*

Anna Klimkowicz, *Secretary*

Peter Dombrowski

Steven Rosenblum

Robert LeFevre, Jr.

Edward Yung

Daniel E. Cates, *Superintendent*

# COLLEGE COMPARISON CHART

DATA TO OBTAIN	COLLEGE #1	COLLEGE #2	COLLEGE #3
Academic Program (largest-best-yours)			
Extracurricular activities (largest-best-yours)			
Average ACT/SAT scores of current freshman class			
Average G.P.A. of last year's freshman class			
Enrollment (both graduate and undergraduate)			
Number of students in current freshman class			
% of last year's freshman class who returned for sophomore year			
Town where school is located			
Campus setting (urban-suburban-rural-small town)			
Distance (driving time in hours)			
% of freshman classes with more than 50 students			
% of commuter students			
% of out-of-state students			
% of minority students			
% of traditional age students			
% of those who graduate in 4 years			
% of undergraduate student body in dorms			
% of dorm residents on campus during weekends			
Cost for first year (tuition-fees-room-board-books)			
% of demonstrated financial need being met			
% of financial aid which is gift aid (scholarships & grants)			
% of financial aid which is self-help (loans-work study)			
Admissions requirements regarding high school record			
Admissions requirements regarding test scores			
Admissions requirements regarding high school course selection			
Application fee information			
Application period (start-end-notification)			
Housing application process			
School's historical significance			
School's religious affiliation			

# ***QUESTIONS TO ASK A COLLEGE REPRESENTATIVE***

1. How many students are there? How many graduate students? What is the male/female ratio?
2. What is the campus like (i.e. size, location, distance to the nearest city or downtown area)?
3. What is the makeup of the student body (i.e. from what states, commuter vs. residential, religious backgrounds, most popular majors)?
4. What is the housing situation? Where can freshmen live? What are the dorms like?
5. What percentage of students return for their sophomore year? What percentage graduate?
6. Do you have my major? What are the strongest majors?
7. What is the average class size for freshmen? For upperclassmen? Are classes typically taught by professors or graduate students?
8. Are there opportunities for research, independent study, internships, or study abroad?
9. What kinds of clubs or activities are there? Is there a greek system on campus? If so, what percent of the student body is involved?
10. Do you have an honors program?
11. Describe the job placement program both during school and after graduation. How about placement in medical or law school ... is there help?
12. Do you have career planning and counseling services?
13. Describe the sports program. In what division does your school compete? How popular are intramurals?
14. Are there special facilities in my interest area (radio/computers/labs/etc.)?
15. What are your admissions standards and what kind of student are you looking for?
16. What is the tuition, room and board, and comprehensive costs of this school?
17. What kinds of financial aid are available, including merit based aid?
18. What arrangements must I make to visit your campus?
19. What are the admissions deadlines I need to know?
20. What is special about this school and why should I attend this one over a similar school?

College Night is for students and parents from all District 211 high schools. It offers students and parents an opportunity to meet with representatives from the colleges and universities listed below.

*Schools will be located alphabetically*

**East Gymnasium (A–M) • Main Gymnasium (N–Z)**

## ***STUDENT CAFE***

### **The Big Ten Universities**

Indiana University  
Michigan State University  
Northwestern University  
Ohio State University  
Penn State University  
Purdue University  
University of Illinois (Auditorium)  
University of Iowa  
University of Maryland  
University of Michigan  
University of Minnesota  
University of Nebraska  
University of Wisconsin

### **Illinois Public Universities**

Chicago State University  
Eastern Illinois University  
Illinois State University  
Northeastern Illinois University  
Northern Illinois University  
Southern Illinois University–Carbondale  
Southern Illinois University–Edwardsville  
University of Illinois at Chicago  
University of Illinois at Springfield  
University of Illinois at Urbana–Champaign  
(Auditorium)  
Western Illinois University

## ***AUDITORIUM***

Session 1 ..... 6:40 - 7:10 p.m. • Session 2 ..... 7:20 - 7:50 p.m. • Session 3 ..... 8:00 - 8:30 p.m.

Harper College (Right) • ISAC – Financial Aid Presentation (Center)  
University of Illinois, Urbana-Champaign (Left)

## ***SPECIAL SESSIONS***

### **Illinois Student Assistance Commission**

There will be a representative from ISAC available to discuss college financial assistance with students and parents.

### **Northwest Educational Counsel for Student Success (NECSS)**

Career Advisors from each District 211 high school will be available to answer your questions about career pathways, career treks, and alignment to possible college majors.

# ***PARTICIPATING COLLEGES AND UNIVERSITIES***

<b>School</b>	<b>City</b>	<b>State</b>	<b>Control</b>	<b>Size</b>
<b>A</b>				
Albion College	Albion	MI	Private	Small
Alma College	Alma	MI	Private	Small
Alverno College	Milwaukee	WI	Private	Small
American Academy of Art	Chicago	IL	Private	Small
Aquinas College	Grand Rapids	MI	Private	Small
Arizona State University	Tempe	AZ	Public	X-Large
Augustana College	Rock Island	IL	Private	Small
Aurora University	Aurora	IL	Private	Medium
<b>B</b>				
Ball State University	Muncie	IN	Public	Large
Beloit College	Beloit	WI	Private	Small
Benedictine University	Lisle	IL	Private	Medium
Blackburn College	Carlinville	IL	Private	Small
Bowling Green State University	Bowling Green	OH	Public	Large
Bradley University	Peoria	IL	Private	Medium
Butler University	Indianapolis	IN	Private	Medium
<b>C</b>				
Cardinal Stritch University	Milwaukee	WI	Private	Small
Carleton College	Northfield	MN	Private	Small
Carroll University	Waukesha	WI	Private	Medium
Carthage College	Kenosha	WI	Private	Small
Central Michigan University	Mt. Pleasant	MI	Public	X-Large
Chicago State University*	Chicago	IL	Public	Medium
Clarke University	Dubuque	IA	Private	Small
Coe College	Cedar Rapids	IA	Private	Small
College for Creative Studies	Detroit	MI	Private	Small
College of Saint Benedict & Saint John's University	St. Joseph	MN	Private	Small
Colorado State University	Fort Collins	CO	Public	X-Large
Columbia College Chicago	Chicago	IL	Private	Large
Concordia University-Chicago	River Forest	IL	Private	Small
Concordia University-Wisconsin	Mequon	WI	Private	Small
Cornell College	Mt. Vernon	IA	Private	Small
Creighton University	Omaha	NE	Private	Medium
Culver-Stockton College	Canton	MO	Private	Small
<b>D</b>				
DePaul University	Chicago	IL	Private	Large
DePauw University	Greencastle	IN	Private	Small
Dominican University	River Forest	IL	Private	Small
Drake University	Des Moines	IA	Private	Medium
<b>E</b>				
Eastern Illinois University*	Charleston	IL	Public	Medium
Eckerd College	St. Petersburg	FL	Private	Small
Elmhurst College	Elmhurst	IL	Private	Small

***COLLEGE SIZE: SMALL - 1-3,000; MEDIUM - 3,001-10,000; LARGE - 10,001-20,000; X-LARGE - 20,001+***

School	City	State	Control	Size
<b>F</b>				
Ferris State University	Big Rapids	MI	Public	Large
Fashion Institute of Design & Merchandising (FIDM)	Los Angeles	CA	Public	Medium
Flashpoint Chicago	Chicago	IL	Private	Small
Florida Atlantic University	Boca Raton	FL	Public	X-Large
Florida Institute of Technology	Melbourne	FL	Private	Small
<b>G</b>				
George Williams College of Aurora University	Williams Bay	WI	Private	Small
Grand Valley State University	Allendale	MI	Public	X-Large
Grinnell College	Grinnell	IA	Private	Small
<b>H</b>				
Harper College•	Palatine	IL	Public	Large
Hillsdale College	Hillsdale	MI	Private	Small
Hofstra University	Hempstead	NY	Private	Medium
Holy Cross College	St. Joseph County	IN	Private	Small
Hope College	Holland	MI	Private	Medium
<b>I</b>				
Illinois College	Jacksonville	IL	Private	Small
Illinois Institute of Technology	Chicago	IL	Private	Small
Illinois State University*	Normal	IL	Public	Large
Illinois Student Assistance Commission	Deerfield	IL		
Illinois Wesleyan University	Bloomington	IL	Private	Small
Indiana State University	Terre Haute	IN	Private	Large
Indiana University*	Bloomington	IN	Public	X-Large
Indiana University Purdue University Indiana (IUPUI)	Indianapolis	IN	Public	X-Large
Iowa State University	Ames	IA	Public	X-Large
Iowa Wesleyan University	Mount Pleasant	IA	Public	Small
<b>J</b>				
Johnson & Wales University	Providence	RI	Private	Medium
Judson University	Elgin	IL	Private	Small
<b>K</b>				
Kalamazoo College	Kalamazoo	MI	Private	Small
Kansas State University	Manhattan	KS	Public	Large
Kent State University	Kent	OH	Public	X-Large
Knox College	Galesburg	IL	Private	Small
<b>L</b>				
Lake Forest College	Lake Forest	IL	Private	Small
Lakeland University	Plymouth	WI	Private	Small
Lawrence Technological University	Southfield	MI	Private	Medium
Lawrence University	Appleton	WI	Private	Small
Les Roches Hospitality Universities	Valais	Switzerland	Private	
Lewis University	Romeoville	IL	Private	Medium
Lincoln College	Normal	IL	Private	Small
Lindenwood University	St Charles	MO	Private	Large
Loras College	Dubuque	IA	Private	Small
Loyola University Chicago	Chicago	IL	Private	Medium

**COLLEGE SIZE: SMALL - 1-3,000; MEDIUM - 3,001-10,000; LARGE - 10,001-20,000; X-LARGE - 20,001+**



School	City	State	Control	Size
<b>L</b> (contd.)				
Loyola University New Orleans	New Orleans	LA	Private	Small
Luther College	Decorah	IA	Private	Small
<b>M</b>				
MacMurray College	Jacksonville	IL	Private	Small
Marian University	Fond Du Lac	WI	Private	Small
Marquette University	Milwaukee	WI	Private	Medium
Maryville University	St. Louis	MO	Private	Small
McKendree University	Lebanon	IL	Private	Small
Miami University	Oxford	OH	Public	Large
Michigan State University*	East Lansing	MI	Public	X-Large
Michigan Technological University	Houghton	MI	Public	Medium
Midwestern University- College of Health Sciences	Downers Grove	IL	Private	Small
Millikin University	Decatur	IL	Private	Small
Milwaukee School of Engineering	Milwaukee	IL	Private	Small
Missouri State University	Springfield	MO	Public	Large
Missouri University of Science and Technology	Rolla	MO	Public	Medium
Monmouth College	Monmouth	IL	Private	Small
Morrison Institute of Technology	Whiteside County	IL	Private	Small
Mount Mary University	Milwaukee	WI	Private	Small
<b>N</b>				
National Louis University	Chicago	IL	Private	Medium
North Central College	Naperville	IL	Private	Small
North Park University	Chicago	IL	Private	Small
Northeastern Illinois University*	Chicago	IL	Public	Medium
Northern Illinois University*	Dekalb	IL	Public	Large
Northern Michigan University	Marquette	MI	Public	Medium
Northwestern University*	Evanston	IL	Public	Medium
<b>O</b>				
Ohio State University	Columbus	OH	Public	X-Large
Ohio Wesleyan University	Delaware	OH	Private	Small
Oklahoma State University	Stillwater	OK	Public	X-Large
Olivet Nazarene University	Bourbonnais	IL	Private	Medium
<b>P</b>				
Parkland College - Institute of Aviation	Savoy	IL	Public	Small
Pennsylvania State University	Centre County	PA	Public	X-Large
Providence College	Providence	RI	Private	Medium
Purdue University*	West LaFayette	IN	Public	X-Large
Purdue University Fort Wayne	Fort Wayne	IN	Public	Medium
Purdue University Northwest	Hammond	IN	Public	Medium
<b>Q</b>				
Quincy University	Quincy	IL	Private	Small
<b>R</b>				
Ripon College	Ripon	WI	Private	Small
Robert Morris University	Chicago	IL	Private	Medium
Rockford University	Rockford	IL	Private	Small

**COLLEGE SIZE: SMALL - 1-3,000; MEDIUM - 3,001-10,000; LARGE - 10,001-20,000; X-LARGE - 20,001+**



School	City	State	Control	Size
<b>R</b> (contd.)				
Roosevelt University	Schaumburg	IL	Private	Medium
Ryerson University	Toronto	Canada	Public	X-Large
<b>S</b>				
Sacred Heart University	Fairfield	CT	Private	Medium
Saint Louis University	St. Louis	MO	Private	Medium
Saint Mary's College	Notre Dame	IN	Private	Small
Saint Mary's University of Minnesota	Winona	MN	Private	Small
Saint Xavier University	Chicago	IL	Private	Small
School of the Art Institute of Chicago	Chicago	IL	Private	Medium
Seattle University	Seattle	WA	Private	Medium
Simpson College	Indianola	IA	Private	Small
Southern Illinois University-Carbondale*	Carbondale	IL	Public	Large
Southern Illinois University-Edwardsville*	Edwardsville	IL	Public	Large
State University of New York (SUNY)	Cobleskill	NY	Public	Large
St. Ambrose University	Davenport	IA	Private	Small
St. Ambrose University	Davenport	IA	Private	Small
St. Louis College of Pharmacy	St. Louis	MO	Private	Small
St. Olaf College	Northfield	MN	Private	Medium
Suffolk University	Boston	MA	Private	Medium
Syracuse University	Syracuse	NY	Private	Large
<b>T</b>				
Texas A&M University	College Station	TX	Public	X-Large
Texas Christian University	Fort Worth	TX	Private	Medium
Trinity Christian College	Palos Heights	IL	Private	Small
Trinity International University	Deerfield	IL	Private	Small
<b>U</b>				
University College Dublin	Dublin	Ireland	Public	X-Large
University of Akron	Akron	OH	Public	X-Large
University of Alabama	Tuscaloosa	AL	Public	X-Large
University of Alabama in Huntsville	Huntsville	AL	Public	X-Large
University of Arizona	Tucson	AZ	Public	X-Large
University of Arkansas	Fayetteville	AR	Public	X-Large
University of Chicago	Chicago	IL	Private	Medium
University of Cincinnati	Cincinnati	OH	Public	X-Large
University of Colorado-Boulder	Boulder	CO	Public	X-Large
University of Dayton	Dayton	OH	Private	Medium
University of Denver	Denver	CO	Private	Medium
University of Evansville	Evansville	IN	Private	Small
University of Illinois at Chicago*	Chicago	IL	Public	Large
University of Illinois at Springfield*	Springfield	IL	Public	Medium
University of Illinois at Urbana-Champaign•	Urbana-Champaign	IL	Public	X-Large
University of Iowa*	Iowa City	IA	Public	X-Large
University of Kansas	Lawrence	KS	Public	Large
University of Louisville	Louisville	KY	Public	X-Large
University of Michigan*	Ann Arbor	MI	Public	X-Large
University of Minnesota Rochester	Rochester	MN	Public	Small
University of Maryland*	College Park	MD	Public	X-Large
University of Minnesota-Twin Cities*	Minneapolis	MN	Public	X-Large

**COLLEGE SIZE: SMALL - 1-3,000; MEDIUM - 3,001-10,000; LARGE - 10,001-20,000; X-LARGE - 20,001+**

School	City	State	Control	Size
<b>U</b> (contd.)				
University of Missouri	Columbia	MO	Public	X-Large
University of Missouri-St. Louis	St. Louis	MO	Public	Large
University of Nebraska-Lincoln*	Lincoln	NE	Public	Large
University of Northern Iowa	Cedar Falls	IA	Public	Large
University of Notre Dame	Notre Dame	IN	Private	Large
University of Oklahoma	Norman	OK	Public	X-Large
University of Oregon	Eugene	OR	Public	X-Large
University of Pittsburgh	Pittsburgh	PA	Public	X-Large
University of South Alabama	Mobile	AL	Public	Large
University of Southern California	Los Angeles	CA	Private	Large
University of St. Francis	Joliet	IL	Private	Medium
University of St. Thomas	St. Paul	MN	Private	Small
University of Tampa	Tampa	FL	Private	Medium
University of Tennessee	Knoxville	TN	Public	X-Large
University of Toledo	Toledo	OH	Public	Large
University of Utah	Salt Lake City	UT	Public	X-Large
University of Wisconsin-Green Bay	Green Bay	WI	Public	Medium
University of Wisconsin-Oshkosh	Oshkosh	WI	Public	Large
University of Wisconsin-La Crosse	La Crosse	WI	Public	Medium
University of Wisconsin-Madison*	Madison	WI	Public	X-Large
University of Wisconsin-Milwaukee	Milwaukee	WI	Public	Large
University of Wisconsin-Parkside	Kenosha	WI	Public	Medium
University of Wisconsin - Stevens Point	Stevens Point	WI	Public	Medium
University of Wisconsin-Whitewater	Whitewater	WI	Public	Large
<b>V</b>				
Valparaiso University	Valparaiso	IN	Private	Small
Vanderbilt University	Nashville	TN	Private	Medium
Verto Education				
Viterbo University	La Crosse	WI	Private	Small
<b>W</b>				
Wabash College	Crawfordsville	IN	Private	Small
Wartburg College	Waverly	IA	Private	Small
West Point	West Point	NY	Public	Medium
Western Illinois University*	Macomb	IL	Public	Large
Western Michigan University	Kalamazoo	MI	Public	Large
<b>X</b>				
Xavier University	Cincinnati	OH	Private	Medium

\* Representatives in the Student Cafe      • Representatives/Presentations in the Auditorium

**COLLEGE SIZE: SMALL - 1-3,000; MEDIUM - 3,001-10,000; LARGE - 10,001-20,000; X-LARGE - 20,001+**



Welcome to the

# COLLEGE FAIR

REGISTER  
FOR A  
BARCODE AT  
**STRIVEFAIR.COM**



If you require assistance while using a District 211 school, please contact the principal's office.

For individuals who are deaf or hard of hearing, please access the following TTD/TTY telephone number: (847) 755-6654.

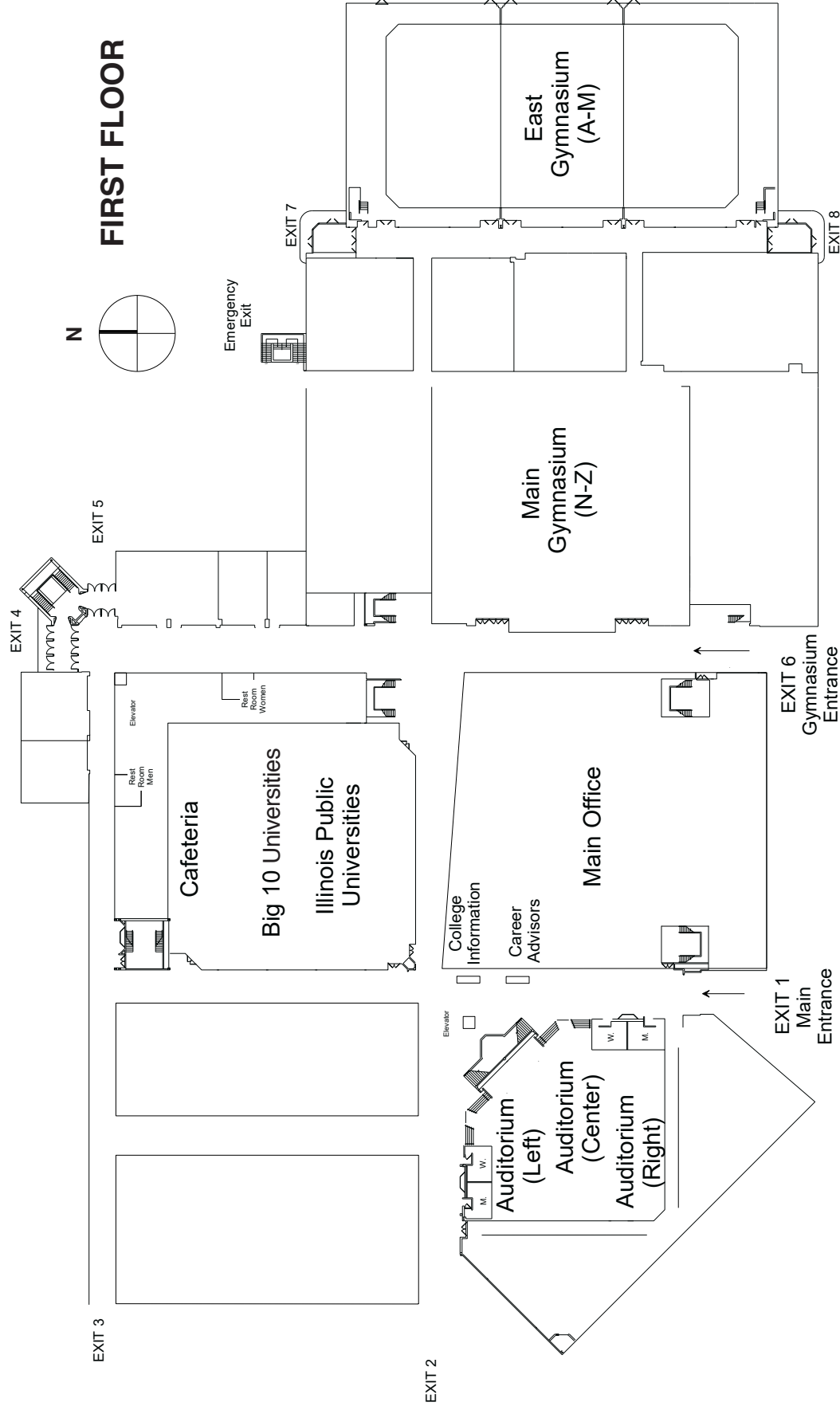

## AUDITORIUM

LEFT = University of Illinois – Urbana-Champaign  
 CENTER = ISAC – Financial Aid  
 RIGHT = Harper College